

# SPJ Power type, Standard

## 单只卷绕功率型

- Low Leakage Current. 低漏电流
- Long charge-discharge cycle life 充放电循环寿命长
- Ultra-low leakage current, suitable for use with battery 超低漏电流，适合于电池配合使用
- Can be used for gas meter, water meter, heat meter power shut valve, meter reading system etc. 可用于燃气表、水表、热量表断电关阀，抄表系统等

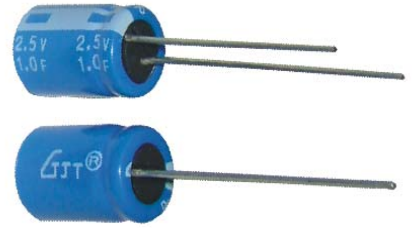

### Specifications 特性表

Items 项目	Characteristics 主要特性	
Rated Voltage 额定工作电压	2.5V <sub>dc</sub>	
Surge Voltage 浪涌电压	3.3V	
operating Temperature 使用温度	-40 ~ +70°C	
Temperature Characteristics 温度特性	Capacitance Change 静电容量变化率	
	+70°C/25°C	Within ±30% initial value 初始值的±25%以内
	-25°C/25°C	Within ±50% initial value 初始值的±25%以内
Endurance 耐久性	ESR 串联等效电阻	
	≤100% of specified value 不大于规范值的100%	
	≤400% of specified value 不大于规范值的400%	
The following specification shall be satisfied when the capacitors are restored to 20°C after subjected to nominal voltage is applied for the specified period of time at 70°C. 在70°C环境中,施加额定电压,连续加载规定时间的额定电压后,待温度恢复到20°C进行测量时,应满足以下要求。		
Test Time 测试时间	1,000Hrs	
Capacitance Change 静电容量变化率	Within ±30% initial value 初始值的±30%以内	
ESR 等效串联电阻	≤300% of initial value 不大于初始值得3倍	

### Drawing(Unit: mm) 外形图

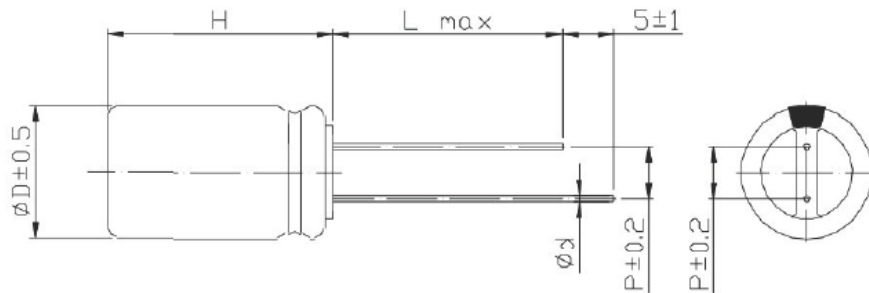

### Standard ratings 标准品一览表

Rated Capacitance 额定容量(F)	ESR(mΩ)		Rated Current 额定电流	Max. Current 最大电流	Max. energy 最大能量(mWh)	Max. Power 最大功率(W)	Size 产品尺寸 (mm)		
	DC	1KHz					Dim. 直径	Hight 高度	Pitch 脚距
0.35	500	250	0.15	0.42	0.3	3.13	5	12	2
0.5	700	350	0.15	0.68	0.43	2.23	6.3	9	2.5
0.7	600	300	0.27	0.8	0.61	2.6	8	13	3.5
1	800	400	0.3	0.92	0.87	1.95	6.3	9	2.5
1	600	300	0.3	0.92	0.87	2.6	8	13	3.5
2	260	130	0.58	2	1.74	6.01	10	20	5
3.3	240	120	0.75	2.4	2.86	6.51	8	20	3.5
3.3	140	70	0.75	2.4	2.86	11.16	10	20	5
4	140	70	1.1	3.3	3.47	11.16	10	20	5
4.7	120	60	1.35	4.4	4.08	13.02	10	20	5
6	120	60	1.5	4.6	5.21	13.02	10	25	5
7	160	80	1.5	4.7	6.08	9.77	10	20	5
8	100	50	1.6	4.8	6.94	15.63	12.5	21	5
10	90	45	2.8	8	8.68	17.36	12.5	26	5
12	90	45	3.2	9.1	10.42	17.36	12.5	34	5
15	60	30	3.97	12.5	13.02	26.04	16	26	7.5
20	50	25	5.1	13.5	17.36	31.25	16	26	7.5
20	46	23	5.1	13.5	17.36	33.97	16	34	7.5
25	50	25	4.6	28	21.7	31.25	16	34	7.5
30	40	20	6.5	18.8	26.04	39.06	16	34	7.5
50	40	20	10	23	43.4	39.06	18	42	8
60	40	20	11	24	52.08	39.06	18	42	8

Note: All design and specifications are for reference only and is subject to change without prior notice. If any doubt about safety for your application, Please contact us immediately for technical assistance before purchase.

注: 以上所提供的设计及特性参数仅供参考, 任何修改不作预先通知, 如有使用上任何疑问, 请在采购前与我们联系, 以便提供技术上的协助。