

SEJ

Energy type, Standard
卷绕结构单只能量型

- Low Leakage Current.
低漏电流
- Long charge-discharge cycle life
充放电循环寿命长
- Ultra-low leakage current, suitable for use with battery
超低漏电流，适合于电池配合使用
- Can be used in toys, tax control equipment, household appliances controllers.
可用于玩具、税控设备、家电控制器等

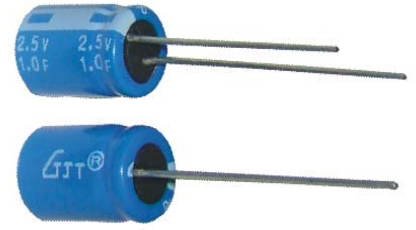

Specifications 特性表

Items 项目	Characteristics 主要特性		
Rated Voltage 额定工作电压	2.5V _{dc}		
Surge Voltage 浪涌电压	2.65V		
operating Temperature 使用温度	-25 ~ +70°C		
Temperature Characteristics 温度特性	Capacitance Change 静电容量变化率		ESR 串联等效电阻
	+70°C/25°C	Within ±30% initial value 初始值的±25%以内	≤100% of specified value 不大于规范值的100%
	-25°C/25°C	Within ±50% initial value 初始值的±25%以内	≤400% of specified value 不大于规范值的400%
Endurance 耐久性	The following specification shall be satisfied when the capacitors are restored to 20°C after subjected to nominal voltage is applied for the specified period of time at 70°C. 在70°C环境中,施加额定电压,连续加载规定时间的额定电压后,待温度恢复到20°C进行测量时,应满足以下要求。		
	Test Time 测试时间	1,000Hrs	
	Capacitance Change 静电容量变化率	Within ±30% initial value 初始值的±30%以内	
	ESR 等效串联电阻	≤300% of initial value 不大于初始值得3倍	

Drawing(Unit: mm) 外形图

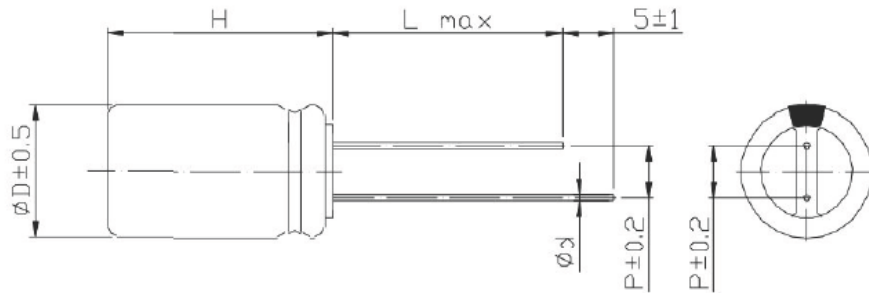

Standard ratings 标准品一览表

Rated Capacitance 额定容量(F)	ESR(mΩ)		Rated Current 额定电流	Max. Current 最大电流	Max. energy 最大能量(mWh)	Max. Power 最大功率(W)	Size 产品尺寸(mm)		
	DC	1KHz					Dim. 直径	Hight 高度	Pitch 脚距
0.35	1200	600	0.12	0.3	0.3	1.3	5	12	2
0.5	1200	600	0.14	0.48	0.43	1.3	6.3	13	2.5
0.7	1200	600	0.2	0.55	0.61	1.3	8	13	3.5
1	1200	600	0.27	0.65	0.87	1.3	8	13	3.5
2	500	250	0.5	1.2	1.74	3.13	10	20	5
2	500	250	0.5	1.2	1.74	3.13	8	20	5
3.3	500	250	0.9	2.1	2.86	3.13	8	20	3.5
3.3	400	200	0.9	2.1	2.86	3.91	10	20	5
4.7	240	120	1.1	2.6	4.08	6.51	12.5	21	5
8	200	100	1.6	3.2	6.94	7.81	12.5	21	5

Note: All design and specifications are for reference only and is subject to change without prior notice. If any doubt about safety for your application, Please contact us immediately for technical assistance before purchase.

注: 以上所提供的设计及特性参数仅供参考, 任何修改不作预先通知, 如有使用上任何疑问, 请在采购前与我们联系, 以便提供技术上的协助。